

Enhance lace with delicate details by drawing lines in precise areas using the air-powered SugarVeil Icing Dispenser .



Visit www.sugarveil.com for more details.



SugarVeil Confectionery Icing, Icing Dispenser, and the Confectioners' Mats are under patent, trademark, and copyright protection of Waldron LLC.

Helpful tips:

- Ensure that mat is completely dry before use. To dry, place on a baking sheet in a 175 degree oven for a short time and allow to cool completely before spreading with SugarVeil.
- Keep oven temperature low when setting SugarVeil, as it will bake above 135 degrees rather than set. Also be sure to allow heated SugarVeil to cool slightly before testing for doneness.
- For dark colors, mix dry powder color with dry SugarVeil mix before adding water.
- When using liquid or gel food color with SugarVeil, lubricate mat using a **very** scant amount of liquid soybean oil (check label of "vegetable oil") applied with a soft natural hair brush in a circular motion. Do not use spray oil. Blot any residual oil from mat with a thin towel.
- When using the Confectioners' Spreader, take care to spread SugarVeil into (not scrape out of) the mat designs.
- Before spreading a second overall layer of SugarVeil across mat, 'clean' the mat using a slightly damp, thin towel wrapped around a fingertip. Ensure that no moisture enters design lines.
- If SugarVeil is set but you want to remove it from the mat later, turn mat face down onto a table top, or place in a zipped bag.
- **Always** peel mat from the SugarVeil, not vice-versa.
- Store SugarVeil decorations away from sunlight between fresh sheets of parchment in food storage bags.

***When allowed to set at room temperature, SugarVeil will remain flexible a longer period of time than when heated to set.**

Mat care:

To clean mat, soak and use water pressure only . Do not use metal tools on mat. Although mat will withstand temperatures of 350 degrees, do not allow direct contact with interior oven parts (place mat on a baking sheet).

Visit
www.youtube.com/SugarVeil
 to see
SugarVeil Confectionery Icing in action.

Tune in for helpful SugarVeil tips at
[Facebook.com/SugarVeil](https://www.facebook.com/SugarVeil)



©Waldron LLC, 2009-10
 18220 Waldron Drive, P.O. Box 18
 Waldron, MO 64092

Tel. (800) 563-0074/(816) 891-7774
 Email: art@sugarveil.com
www.sugarveil.com



Create delicate lace effortlessly with
SUGARVEIL®
CONFECTIONERS' MATS

SUGARVEIL CONFECTIONERS' MATS

Instructions

One day prior to use, prepare the SugarVeil Icing. Mix 1/3c. plus 2 Tbl. boiling water into 1 cup SugarVeil Confectionery mix (or 1/2 c. boiling water to 5 oz. package of SugarVeil) and immediately beat on high speed for 4 minutes. Cover with plastic wrap. Visit www.youtube.com/sugarveil to see a video showing the below techniques in action.

Directly before use, rebeat the mixture by hand for one minute. Apply a dollop of SugarVeil to mat.



Use the Confectioners' Spreader to spread and 'stretch' repeated layers of the SugarVeil mixture across mat length-wise, crosswise, and diagonally, each stroke continually compressing mixture into design until all incised lines are filled solidly and without air bubbles.



For the final lengthwise swipe, wipe the edge of the spreader clean with a damp cloth and hold with both hands so that edges and open areas of design are clean and sharp.

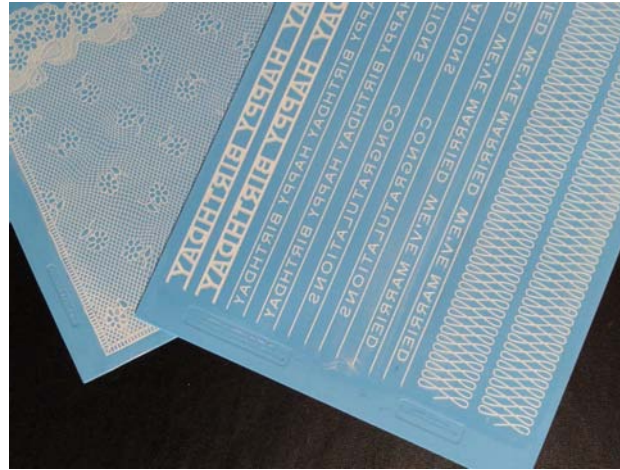
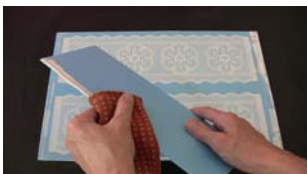

For mats with isolated designs, or for mats of any design where a contrasting effect is desired, a secondary layer of SugarVeil may be applied when the first application is partially set and when touched, does not cling to the finger.



For this second layer, color a portion of the SugarVeil Icing and spread thinly across the entire mat. Use a ball tool or a thumbnail to cleanly scrape a path along each border edge. The icing ridge which results makes it easier to peel the SugarVeil sheet.

Allow the mat to set overnight. This is the preferred method for setting SugarVeil. If 'speed setting' is desired* or if humidity is greater than 50%, place mat on baking sheet in 100 degree oven for approximately 30 to 50 minutes [test for the correct time for your oven, rotating periodically to ensure all areas of the mat are heated equally]. Cool slightly before inspecting for doneness.

At regular room temperature and humidity of 40%, SugarVeil will set in about 3 hours or less

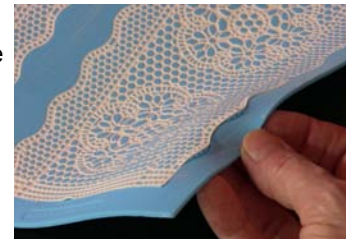

SugarVeil is properly set and may be removed from mat when **all** of the following characteristics apply:

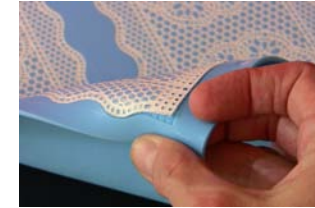

(1) When lifting a corner, SugarVeil is firm and does not stretch out of shape,



(2) SugarVeil separates easily when mat is gently flexed at edge, and

(3) SugarVeil is not at all sticky to the touch

To remove SugarVeil, peel an inch or so from the shorter edge and place mat face down onto table top. Peel the mat back onto itself a few inches and wedge the Confectioners' Spreader between the SugarVeil and the mat to pin down lightly to the table. Peel mat back a few inches and advance the spreader further to pin down the SugarVeil as you peel the mat several more inches. Repeat until the entire mat is peeled from the SugarVeil piece.



Shapes from the lace pieces may be cut with Confectionery Snips, or other small, fine, precise scissors.

Pieces may be painted with gold dust/colored luster powders mixed with grain alcohol, or airbrushed. Lace will stick to any icing surface – if surface is dry, use a scant amount of water on a fingertip. SugarVeil will meld nicely onto the surface of warm breads, pies, pastries, breads, cookies, and candy.